

Automatic sliding doors sealed hermetically in aluminium and stratified in HPL

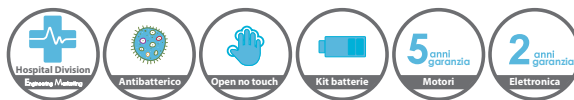

AREEE DI INSTALLAZIONE

- Emergency rooms
- Hospital rooms
- Department entrances
- Radiological rooms
- Waiting rooms
- Offices



Visualize the video of this product with QR technology

ANTI-X PROTECTION

For installations in operating rooms or in ambulances and radiological rooms, in which raggi X machines are used, the doors can be provided with Anti-X protection, created with mediated lead sheet of 1,2 mm or superior and equivalent glass leaded window.



TECHNICAL DESIGNS

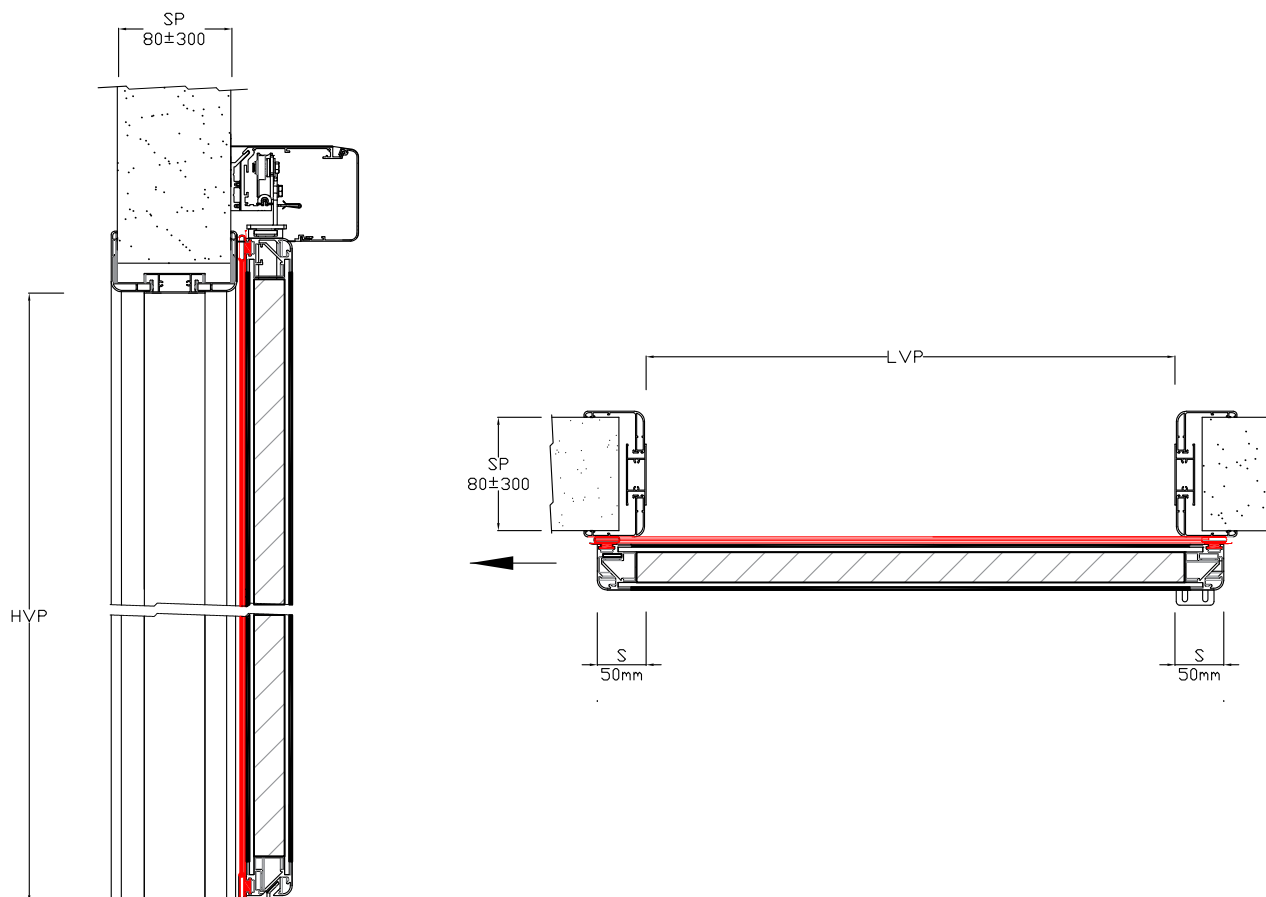

Antipanic push opening System

In case of an exit for emergencies the sliding door leaves and/or the semi-fixed door leaves, recover the pressure, and will be openable for outwards (also when it is moving).

The automatism, is fixed to the floor throughout the driving, and permits, the side collection of door leaves, with the disarming of automatic functions, to the restoration of the exercising function that goes along with the manual rearming.

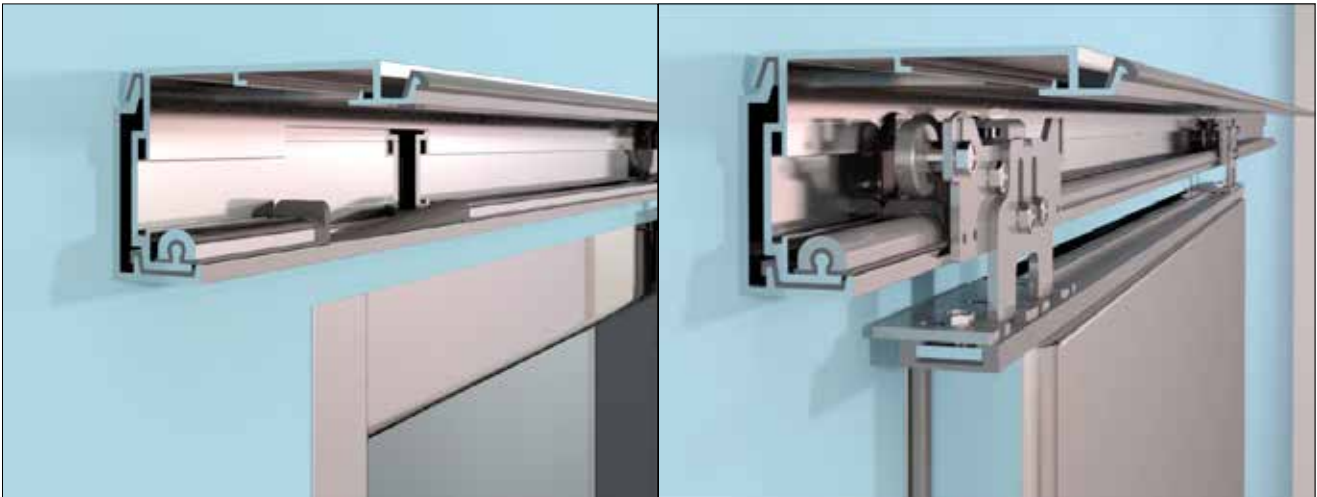

Redundant anti-panic system

Thanks to a series of technical precautions that guarantee the emergency opening, the redundant system are used as alternative to the sliding doors anti-panic mechanical push opening.

In absence of alimentation the opening of the passage is guaranteed from the batteries of emergency, NiMH constantly monitored. In case of a breakdown, the opening of the door is secured from the second emergency motor, after that the door leaves remain open until the anomaly is not resolved.

The correct function of the intern system, that comprehends an encoder to observe the position of the door leaf, comes verified at least once ever 24 hours from a double cycle of control.

Thanks to the norm EN16005 from the "Automatic Security Pedestrian Doors" the system redundant comes recognized as anti-panic system without function of push opening, useable at the emergency exits poste to the escape roots.

PHOTO GALLERY

Hospital Doors System



PHOTO GALLERY

